

HOW TO PREPARE READY-TO-FEED INFANT FORMULA

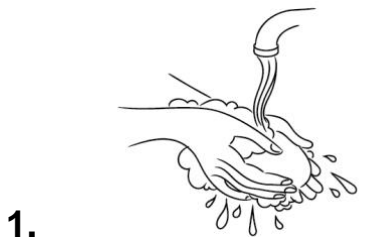

1. Disinfect kitchen counter and wash hands with soap and water.



5. Shake the can well before opening it with a sterile can opener.

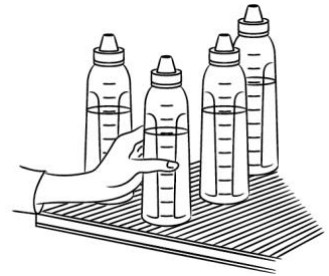

8. Put prepared bottles in refrigerator. **Use within 24 hours.**



2. Have sterilized equipment ready on clean paper towel.



6. Divide infant formula in sterile bottles by pouring the amount of infant formula needed for one feeding in each sterilized bottle (preferably glass).



9. If there is any formula left over in the can, tightly cover the opened can and put it in the refrigerator. **Use within 48 hours.**



3. Check the expiry date and make sure there are no dents on the can.

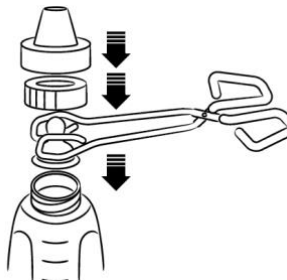

7. Pick up nipples, rims and caps with sterilized tongs and put on bottles. Tighten with your hands.



4. Wash top of can with warm water.

For more information on infant formula recalls, please visit the Canadian Food Inspection Agency website www.inspection.gc.ca.

Adapted with permission from Ottawa Public Health.

